

GitHub Setup

ENV 872 – 2022

Luana Lima & John Fay

GitHub Setup

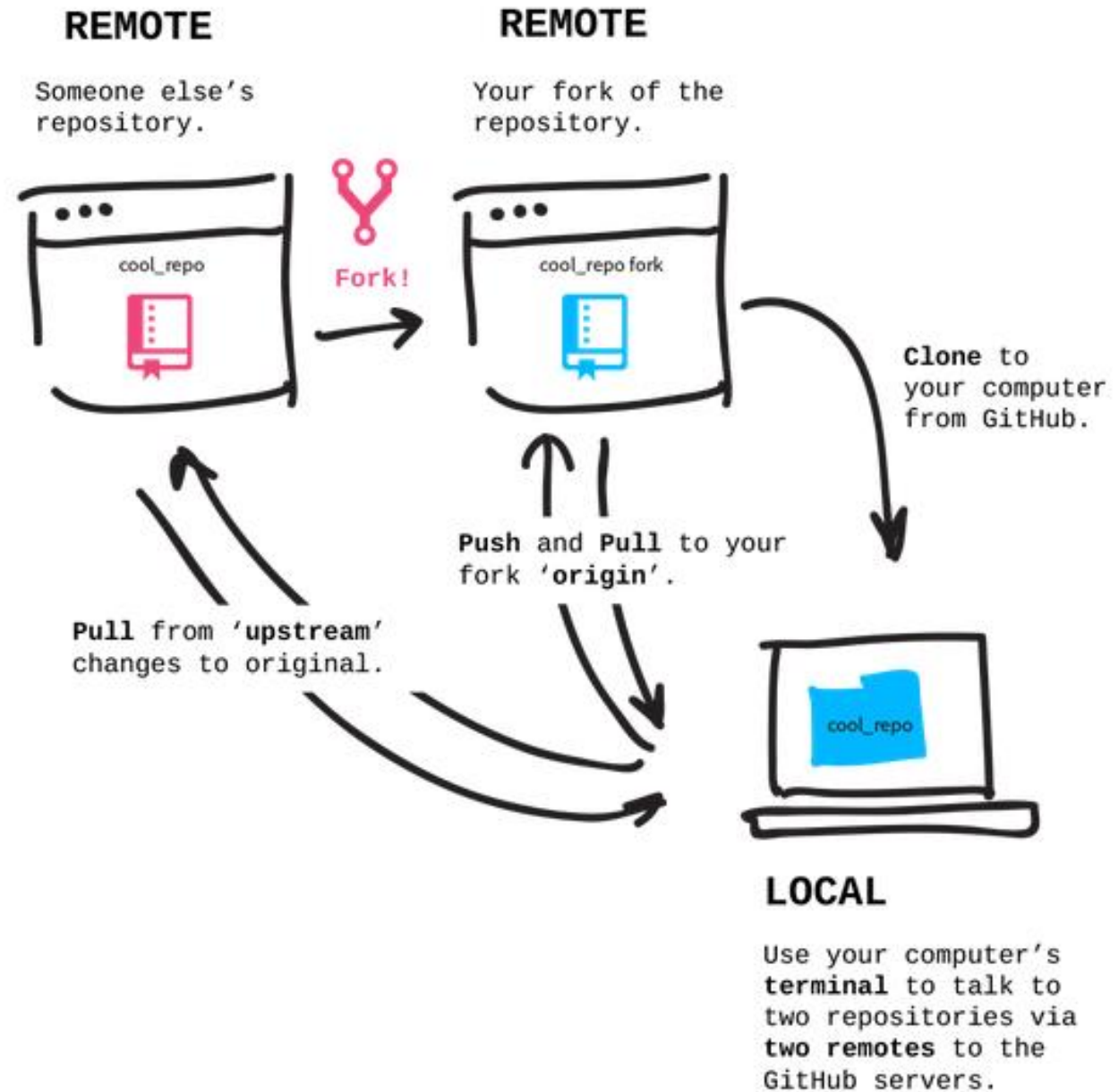

GitHub Setup: *Forking*

1. Navigate to:
https://github.com/ENV872/Environmental_Data_Analytics_2022
2. Log in using your GitHub username and password
3. Fork the repository to your GitHub account

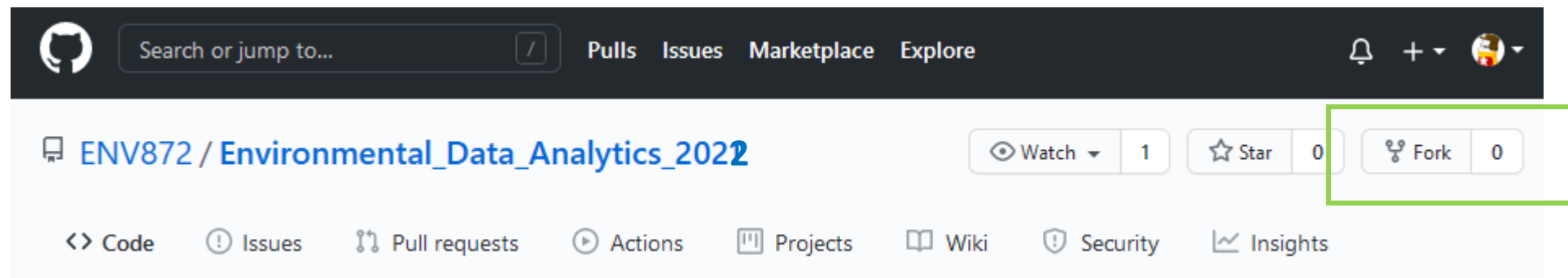

GitHub Setup: *Cloning*

4. Copy the link to your forked repository

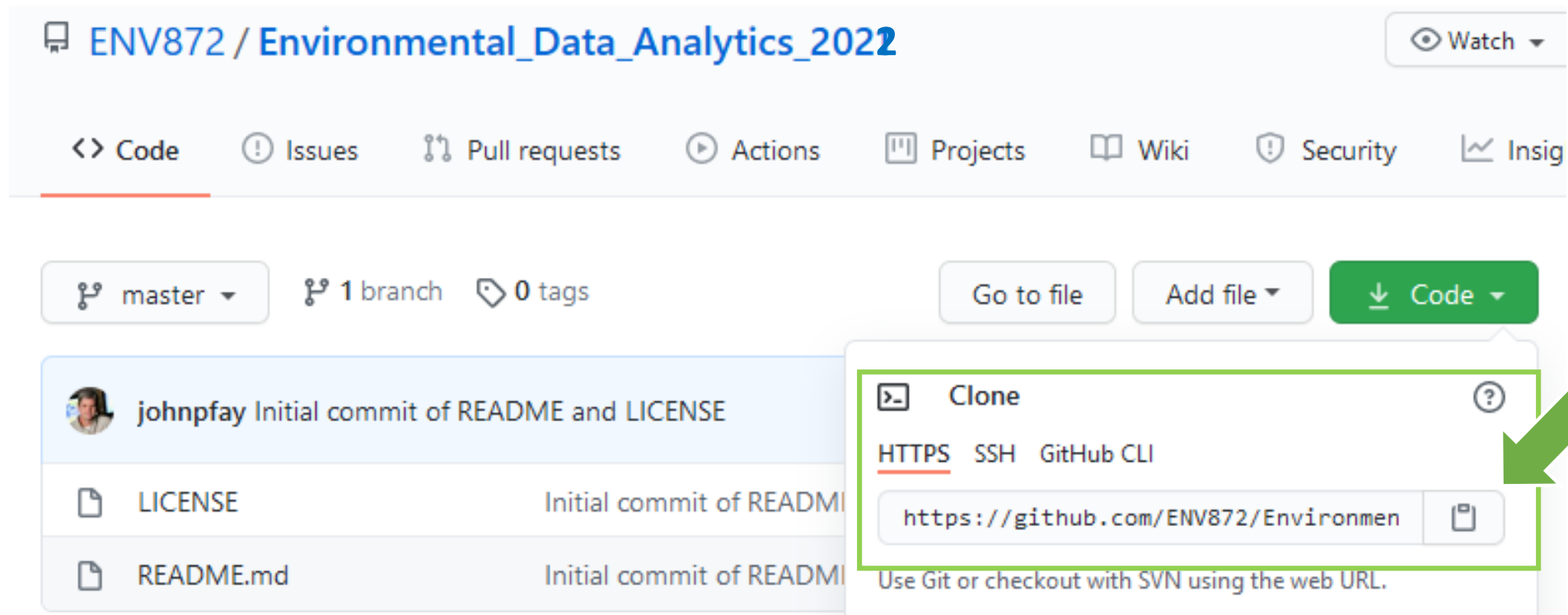

The screenshot shows the GitHub interface for a repository named 'ENV872 / Environmental_Data_Analytics_2022'. The 'Code' tab is selected. Below the repository name, there are buttons for 'master', '1 branch', and '0 tags'. To the right, there are buttons for 'Go to file', 'Add file', and a green 'Code' button. A dropdown menu is open from the 'Code' button, showing options for 'Clone', 'HTTPS', 'SSH', and 'GitHub CLI'. The 'Clone' option is highlighted with a green box, and a green arrow points to it. Below the 'Clone' option, the URL 'https://github.com/ENV872/Environmen' is displayed with a copy icon. At the bottom of the dropdown, it says 'Use Git or checkout with SVN using the web URL.'

ENV872 / Environmental_Data_Analytics_2022

Watch

Code Issues Pull requests Actions Projects Wiki Security Insig

master 1 branch 0 tags

Go to file Add file Code

Clone

HTTPS SSH GitHub CLI

https://github.com/ENV872/Environmen

Use Git or checkout with SVN using the web URL.

GitHub Setup: *Cloning*

5. Open Rstudio and go to File > New Project
6. Select “Version Control”, then “Git”
7. Paste your forked repo URL and choose a folder where the local repository will be saved

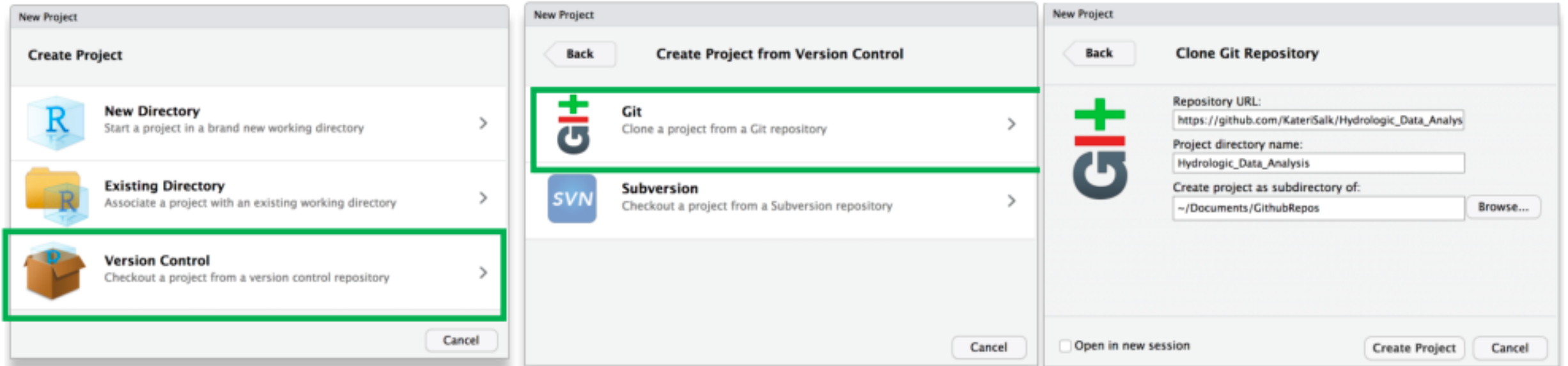

GitHub Setup: *Commit & Push*

Open the Git_Help file; follow instructions on the Editing, Committing, & Pushing.

1. Navigate to the "README.md" file in the Files tab and open it.
2. Type your name after "Student:" and save.
3. Now that you have edited a file, it should now appear in the Git tab. Click the box to the left of the file, where a check mark should now appear.
4. Press the "Commit" button. A new window should appear that shows the changes that have been made to the file.
5. Write a message detailing the edits you've made to the README file. You should always include a commit message to your commits so that your future self and/or your collaborators will know what changes were made. Click "Commit".
6. Click the green upward facing arrow: the "Push" button. Your remote repository is now up to date with your local repository.

GitHub Setup: *Add & Pull from Remotes*

Follow the instructions in the “Pulling from the upstream remote” section of the Git_Help file.

1. In the Terminal tab, type:
`git remote add upstream https://github.com/ENV872/Environmental_Data_Analytics_2022`
2. In the Terminal tab, type:
`git pull upstream main`